

SAFETY CHARACTERISTICS	0
SIGNIFICANT CHARACTERISTICS	0

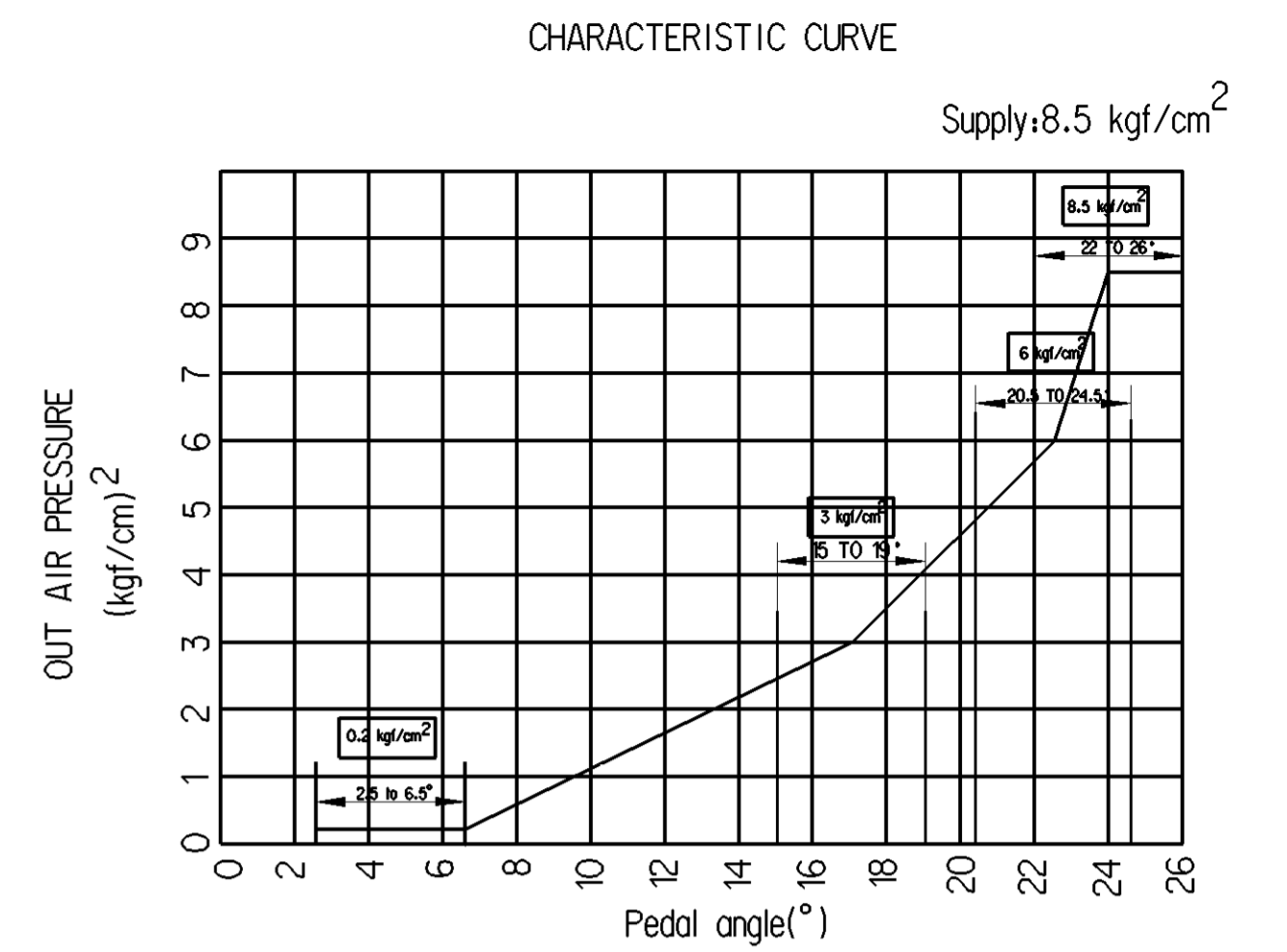

Pedal angle(°)	2.5-6.5	15-19	20.5-24.5	22-26
Out air pressure(Kgf/cm) <sup>2</sup>	0.2	3	6	8.5

- AIR LEAK TEST (NORMAL TEMPERATURE)
    - 1-1.STATIC : OUT AIR PRESSURE 7.0 kgf/cm<sup>2</sup>  
LEAKAGE : WITHIN 3 sec. < 30pa
    - 1-2.DYNAMIC : OUT AIR PRESSURE 7.0 kgf/cm<sup>2</sup>  
LEAKAGE : WITHIN 3 sec.<30pa
  - TIGHTENING TORQUE
    - 2-1. (2) x7 M8 BOLT : 17±3.5 N-m
  - MAXIMUM SUPPLY PRESSURE : 8.5 kgf/cm<sup>2</sup>
- (4) STICKER PASTING LOCATON

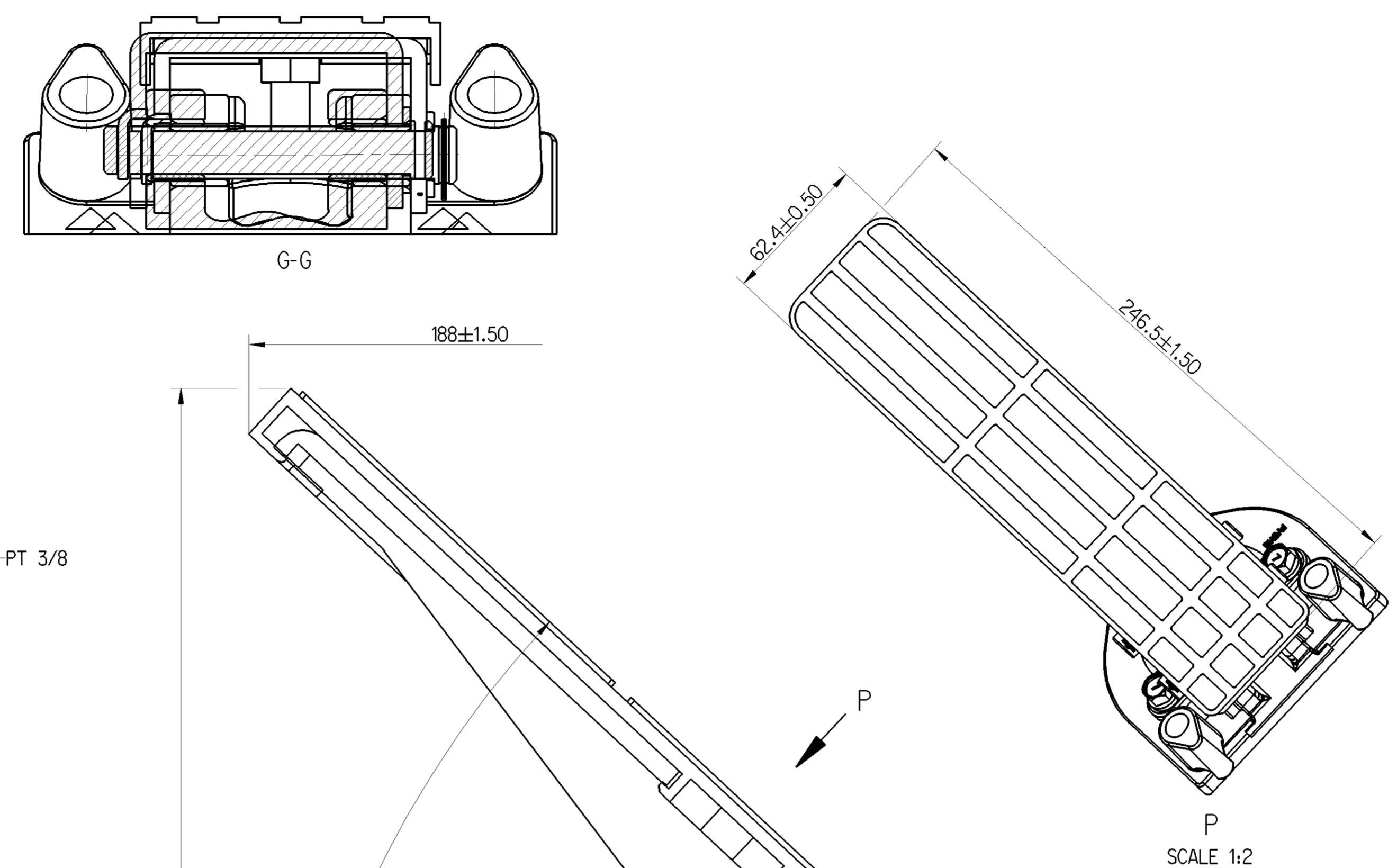
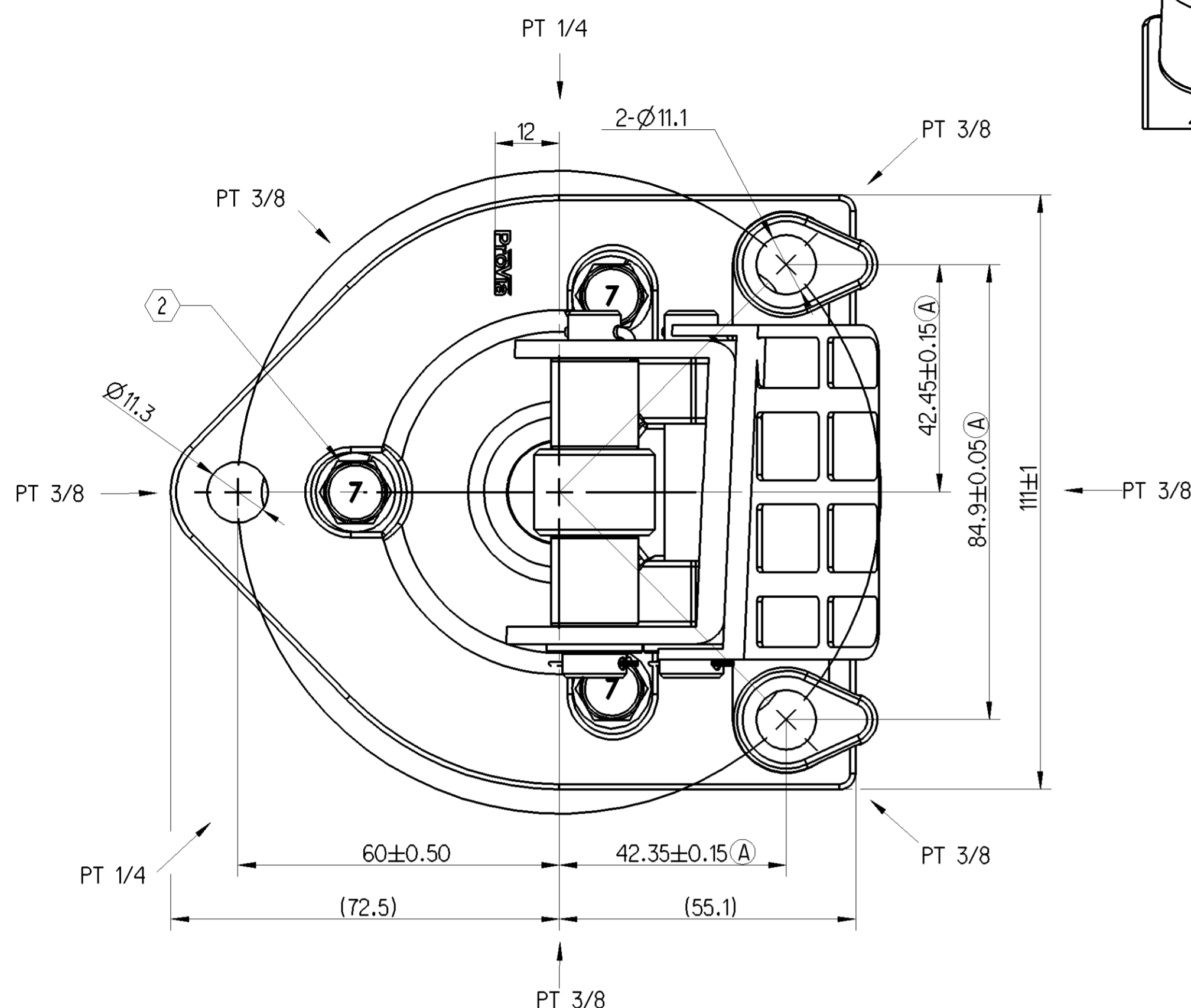
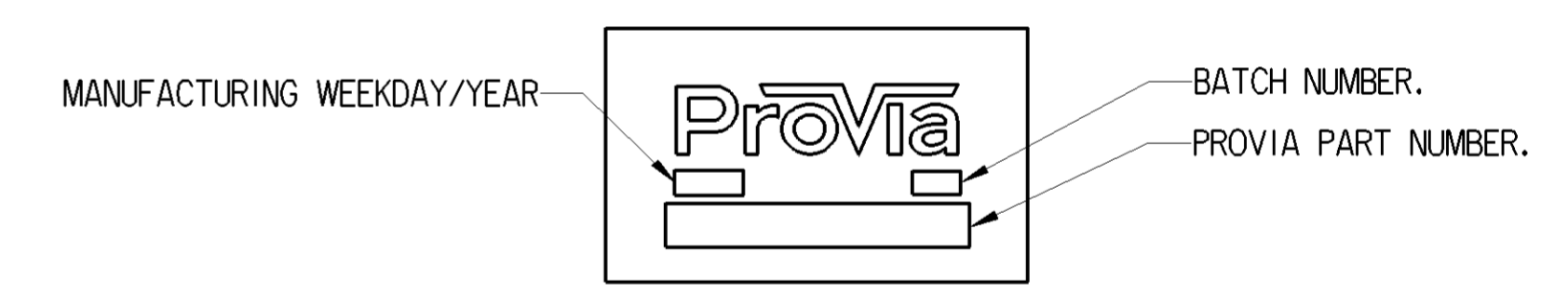

(5) LOGO SIZE : 16 x 4  
FOR PROVIA LOGO SPECIFICATION REFER JED-868

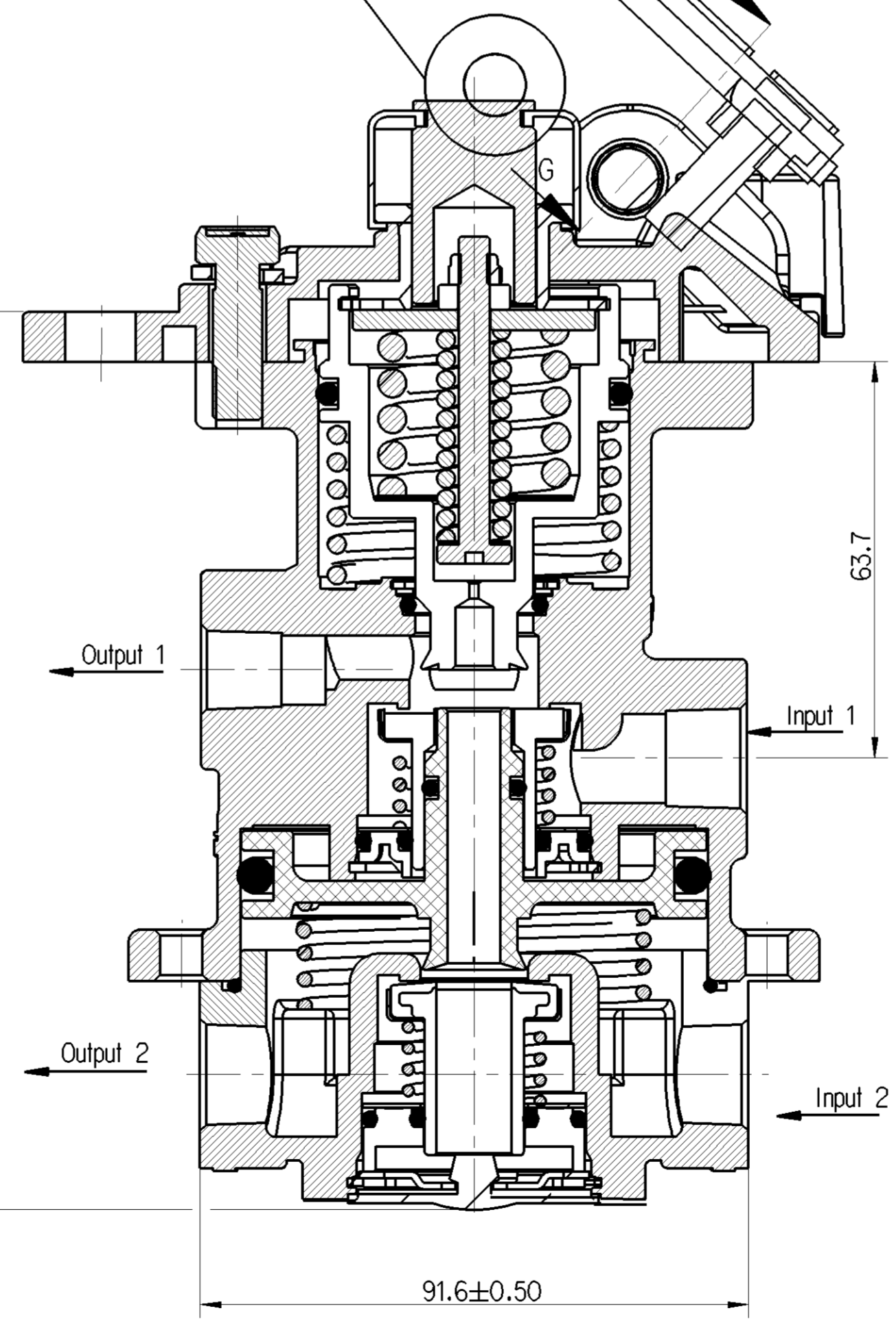
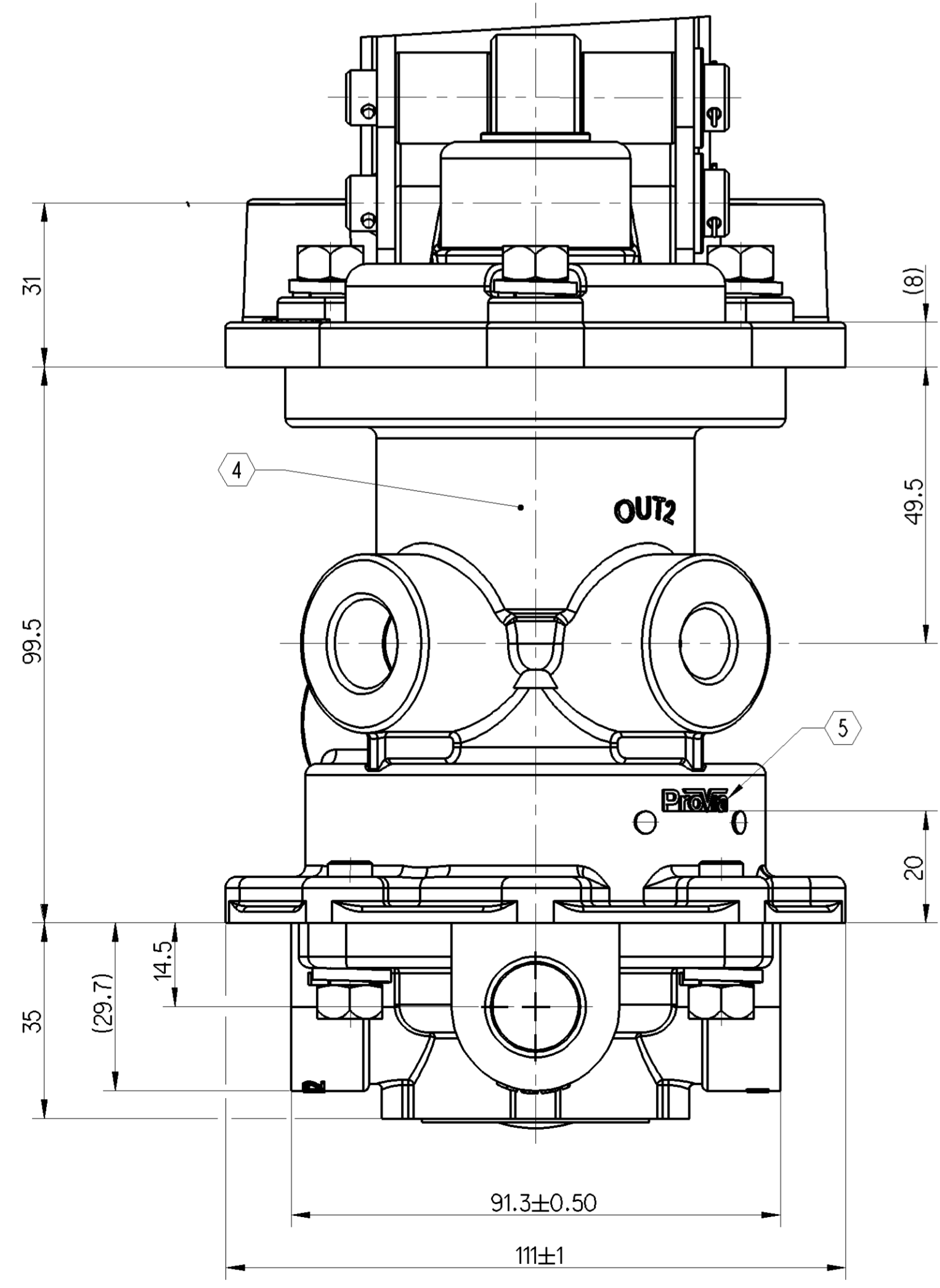

General Specifications: JED-334-1 - Size ISO 14405 LP		Copyright WABCO®	
Further Technical Data: PRO 315 003 0		Date: 2019-01-29	Signature: Smpath
Doc. Code: 035		Sheet: 01	To: 06
General Tolerances JED-261		Checked: Yerachelvan	
Range of Nominal Dimensions ( ± mm)		Expert: Suresh Gayakwad	
Class	1) ≤ 50	2) > 50 ≤ 180	3) > 180 ≤ 400
Fine	0.5	1.0	1.5
Medium	1.0	2.0	3.0
Coarse	2.0	3.5	5.0
Tapped Holes acc.		1) Tolerance Class Applied Crossmarked	
Mass	2.44 kg	Scale	1:1 (1:2)
Size	A 1	Material No.	PRO 315 003 0
Date of first issue: 2019-01-04		Doc.Code	005
Language		EN	1/1
Revision		3x	5180_AM
Tech. Resp.		Replacement for	

Non e permesso copiare o riprodurre questo documento, ne utilizzare i contenuti a fini commerciali, senza permesso scritto dalla WABCO. E' vietata espressamente la ristampa o l'uso non autorizzato. Tutti i diritti sono riservati. WABCO e i suoi marchi sono marchi registrati di WABCO. Tutti gli altri nomi di marchi o di prodotti sono marchi registrati dei rispettivi titolari.