

III	STEEL	ELECTROPHORESIS
II	ALUMINIUM ALLOY	PASSIVATION TREATMENT
I	STEEL	GALVANIZED (WHITE)
POS	MATERIAL	SURFACE PROTECTION

SAFETY CHARACTERISTICS	0
SIGNIFICANT CHARACTERISTICS	0
CUSTOMER INTERFACE	7

- TECHNICAL INFORMATION**
- HYDRAULIC TANK DIA : $\varnothing 25\text{mm}$
 - AIR TANK DIA : $\varnothing 102\text{mm}$
 - HYDRAULIC WORKING PRESSURE 4MPa
 - HYDRAULIC WORKING PRESSURE MAX 12MPa
 - AIR WORKING PRESSURE MAX 1MPa
 - WORKING TEMPERATURE : -40°C TO $+80^{\circ}\text{C}$
 - MEDIUM
 HYDRAULIC MEDIUM : DOT 4 BASED BRAKE FLUID IN ACCORDANCE WITH SAE J 1703
 PNEUMATIC MEDIUM : AIR
 - OIL VOLUME INPUT : $V=(Sh+c)K$
 K : ABSORPTION AT 120 BAR FOR C-O, $K=1.5\text{cm}^3$
 SH : HYDRAULIC SECTIONAL AREA = 4.9 cm^2
 C : GEAR DISENGAGING STROKE
 - OPEN PORTS ARE FITTED WITH CLOSURE PLUG FOR STORAGE AND TRANSPORT PURPOSE
 - CAUTION : DO NOT ACTUATE THE DEVICE IF NOT FITTED ON ITS MOUNTING BRACKET
 - WITHOUT STROKE WEAR INDICATOR
 - DO NOT OPERATE THIS PRODUCT WITHOUT INSTALLATION OR FIXATION ON THE BRACKET

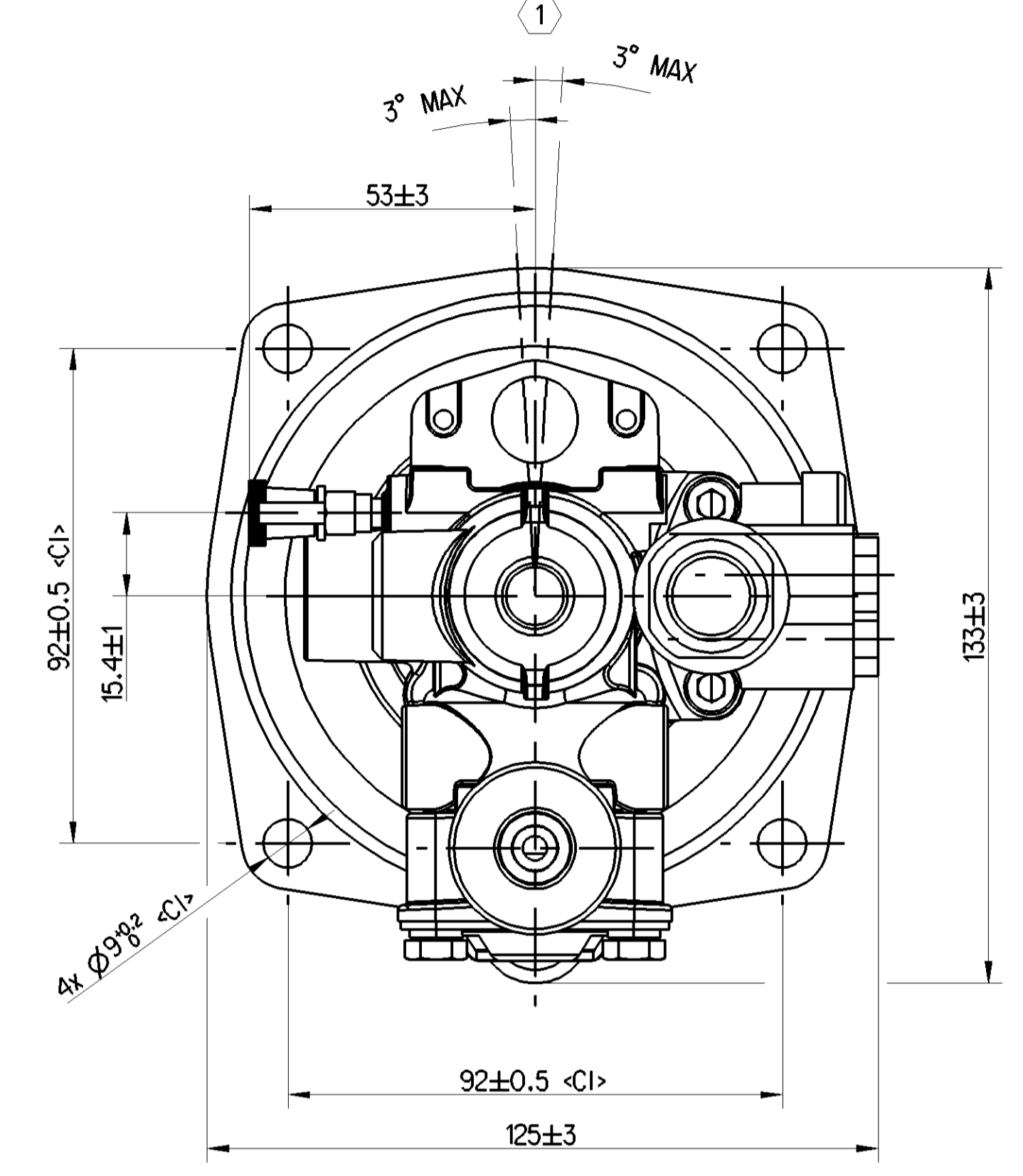
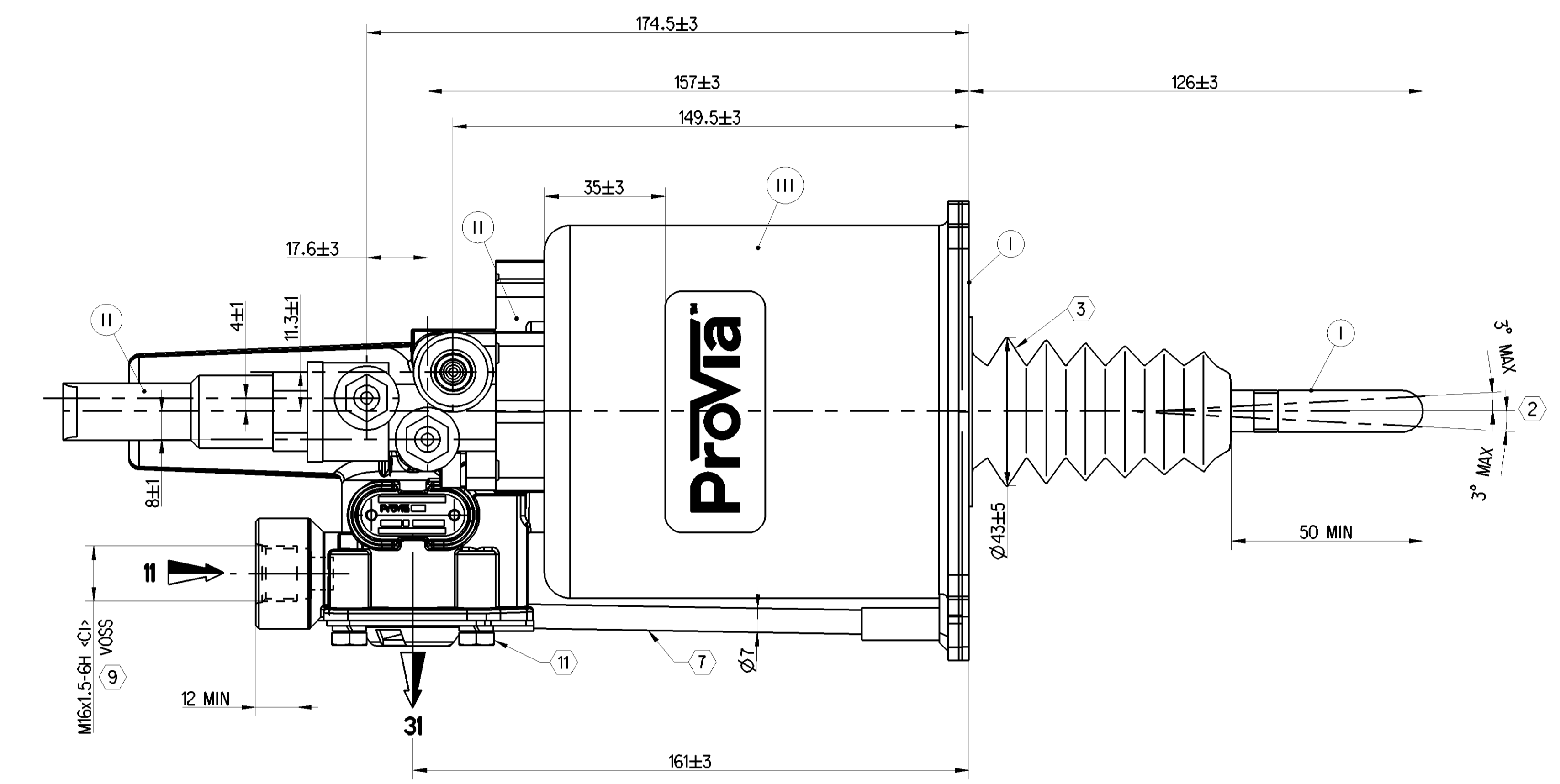

- NOTES**
- DEVICE EXTREME POSITION WHEN BLEEDING
 - MISALIGNMENT OF PUSH-ROD IN ANY DIRECTION
 - BOOT THERMAL RANGE -40°C TO $+130^{\circ}\text{C}$
 - GEAR DISENGAGING STROKE
 - POSITION TO NOTE (CLUTCH IN NEW CONDITION)
 - STROKE
 - DO NOT USE THE TUBE FOR LIFTING PLEASE LABEL TO BE PASTED HERE
- TORQUE FOR CONNECTION**
- | | |
|----|-------------|
| 8 | 25Nm MAX |
| 9 | 34Nm MAX |
| 10 | 5_0^5 Nm |
| 11 | 10_0^5 Nm |

LABEL CONTENT

100

Do not use tube for lifting please label to be pasted here

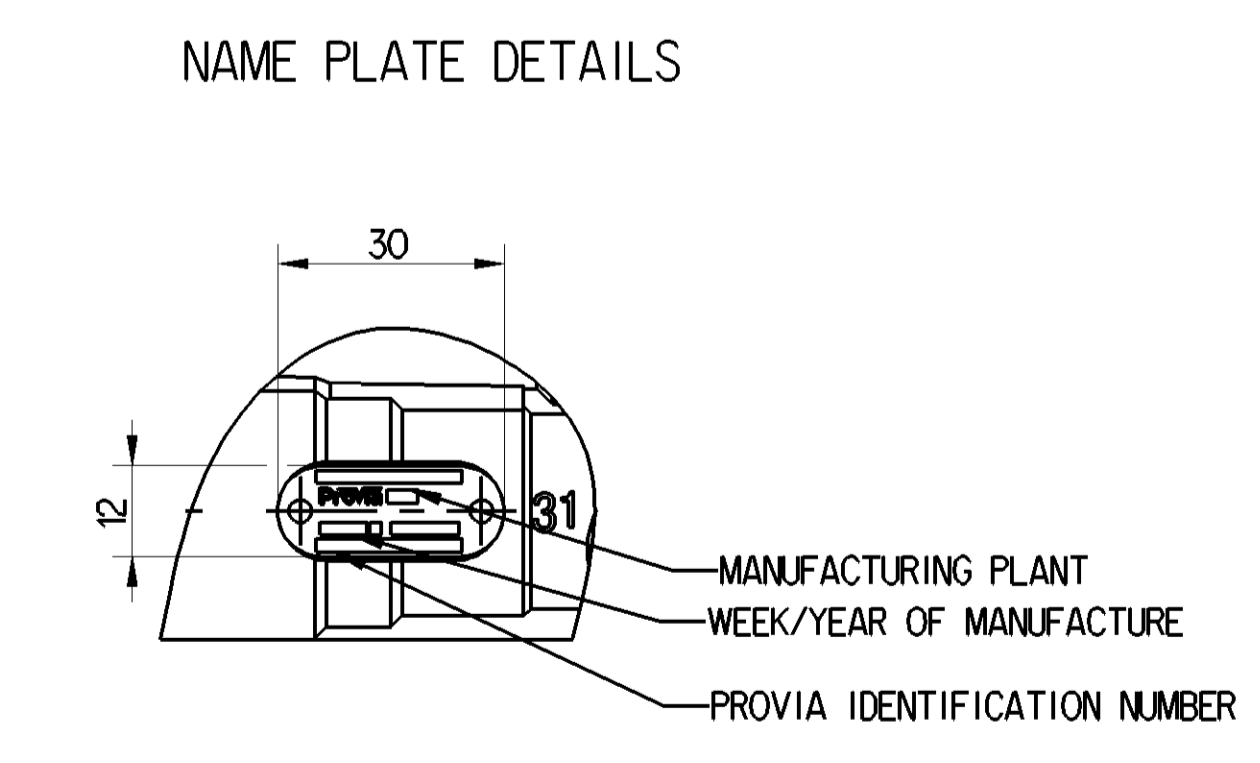
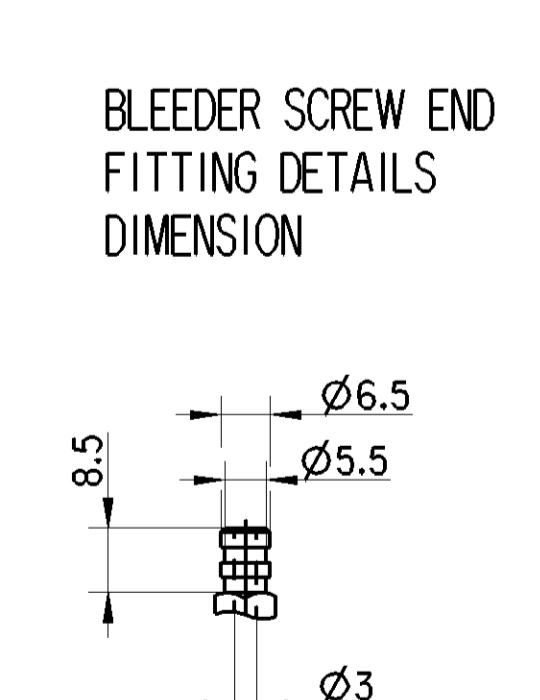
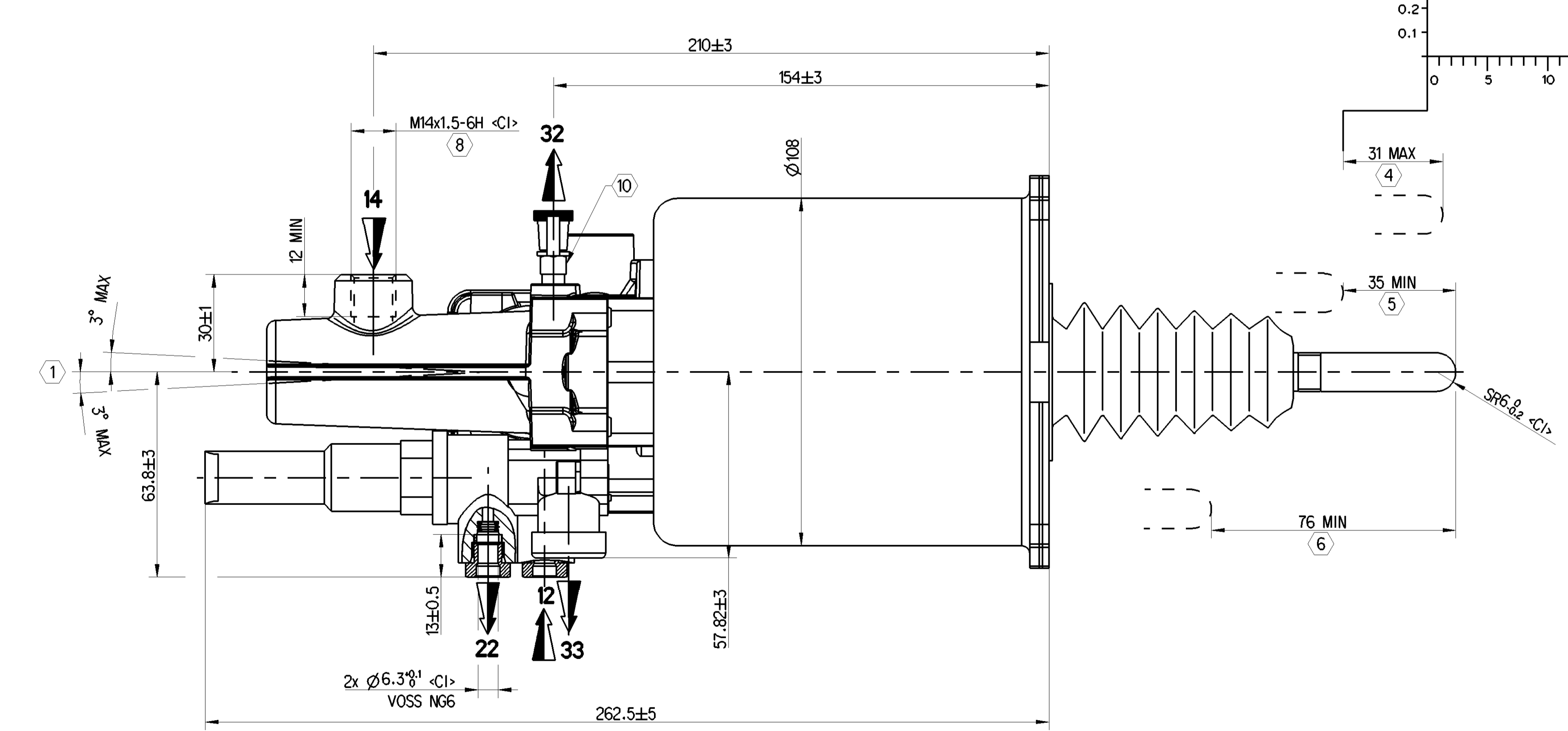
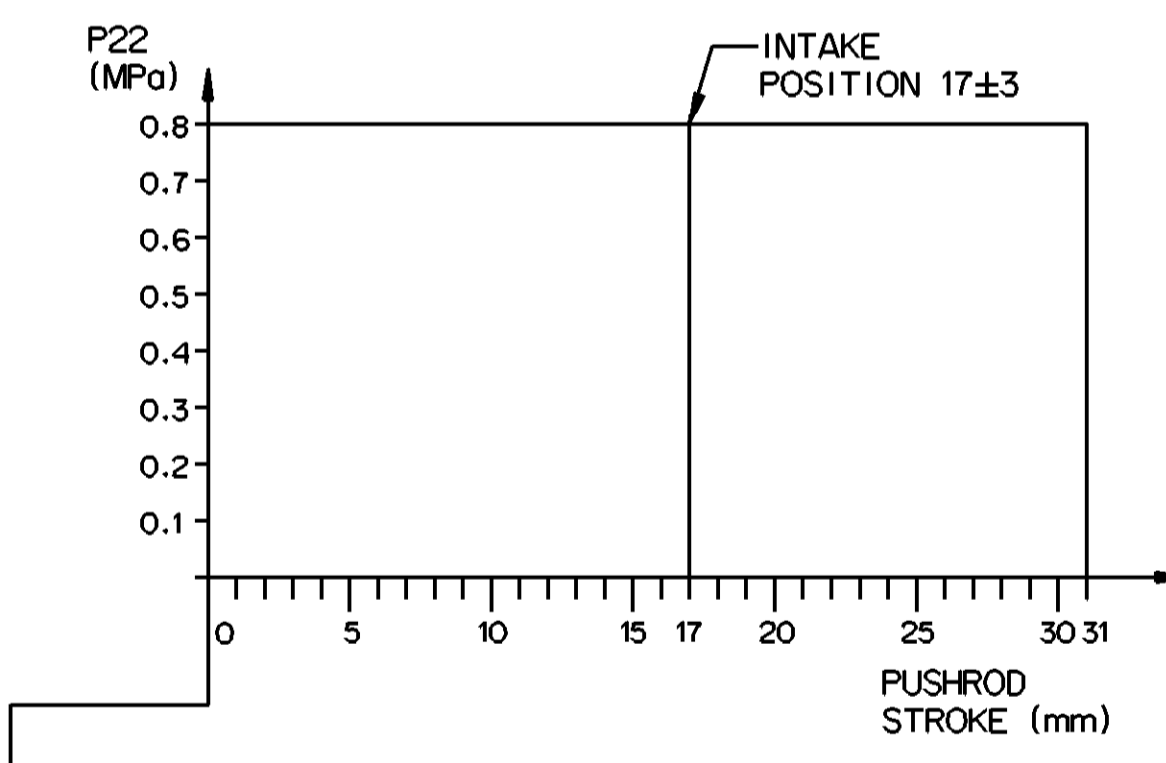
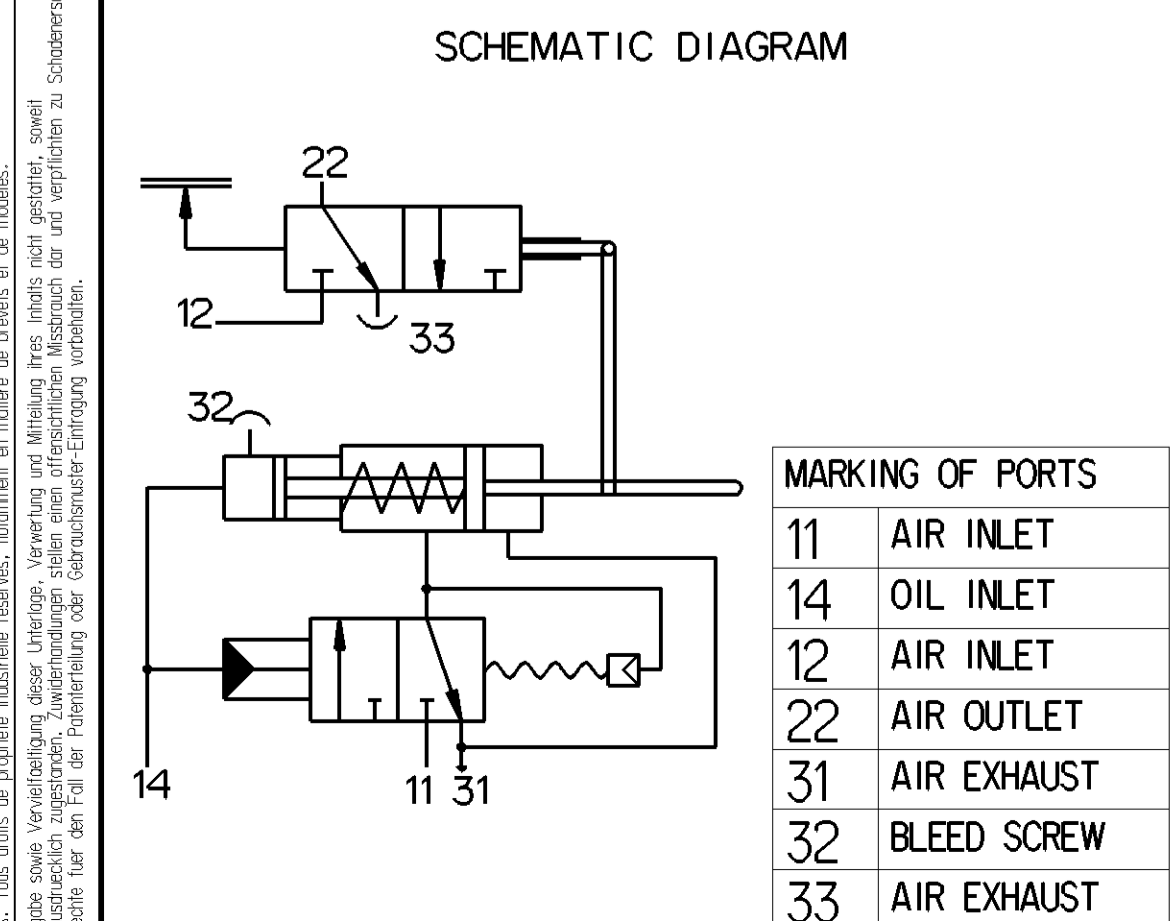
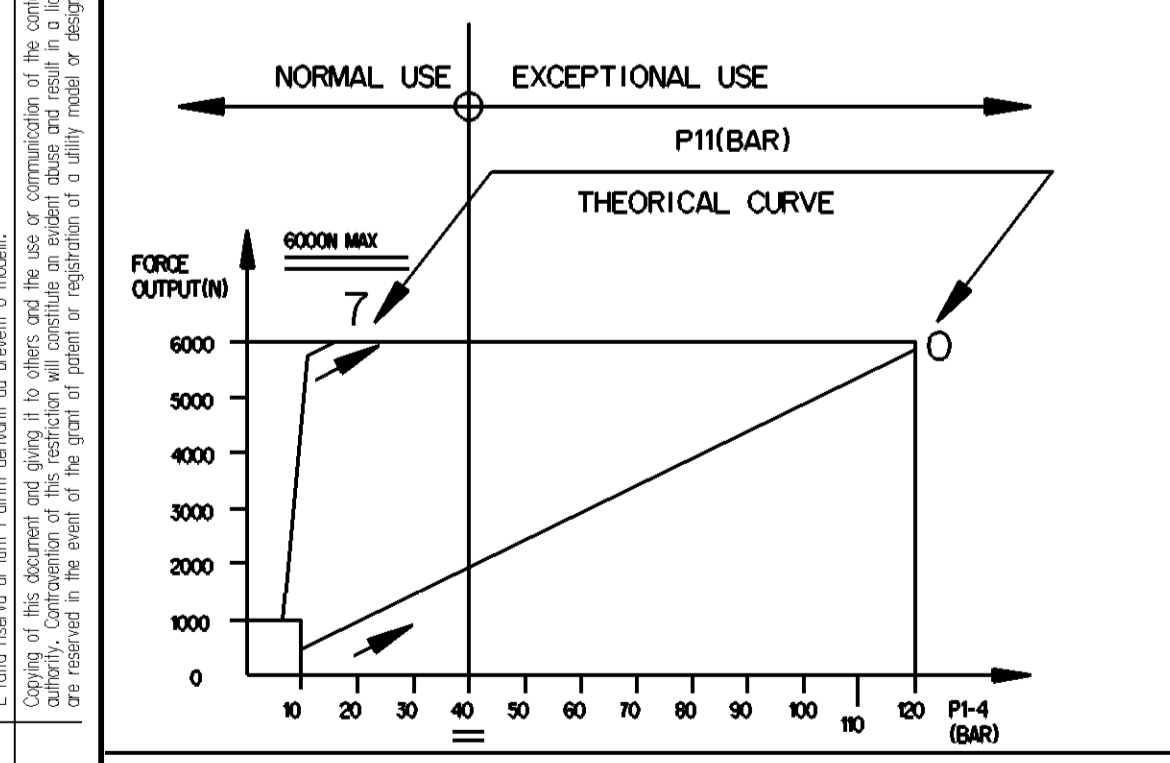
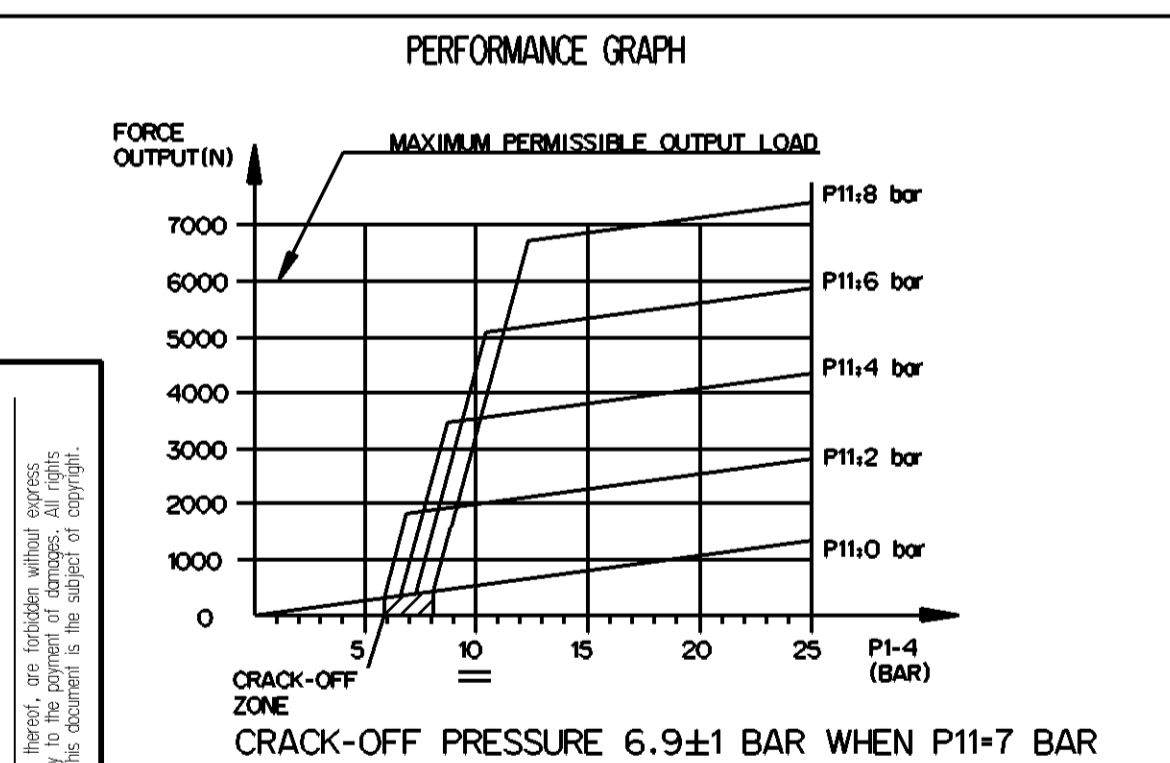

General Specification: ISO 8768, ISO 8769, ISO 10471, Size (S) 14405 LP		Copyright ©		Provia	
Further Technical Data: PRO 411 039 0		Date: 2023-11-08		CLUTCH SERVO	
Doc. Code: 039	Sheet: 1	To: 15	Drawn: KAWA	Checked: MANFREDINI	Approved: MANFREDINI
Range of Nominal Dimensions (d in mm)		Dimensions in mm		Date of First Issue: 2023-11-08	
Class	1	2	3	4	5
File	±0.05	±0.10	±0.15	±0.2	±0.3
Medium	X	±1	±2	±3	±4
Course	±2	±3.5	±5	±6.5	±10
Tapped holes acc.:		2.6		NTS	
Size		A 0		CREO	
CAX System		E39/Rev. 1		Revision	
Part Name		PRO 411 039 0		005 EN 1/1	
Replacement for		5630_04			