

- TECHNICAL INFORMATION**
1. HYDRAULIC TANK DIA :  $\varnothing 22$ mm
  2. AIR TANK DIA :  $\varnothing 102$ mm
  3. HYDRAULIC WORKING PRESSURE 4MPa
  4. HYDRAULIC WORKING PRESSURE MAX 12MPa
  5. AIR WORKING PRESSURE MAX 1MPa
  6. WORKING TEMPERATURE : -40°C TO +80°C
  7. MEDIUM  
HYDRAULIC MEDIUM : DOT 4 BASED BRAKE FLUID IN ACCORDANCE WITH SAE J 1703  
PNEUMATIC MEDIUM : AIR
  8. OIL VOLUME INPUT : V=(SH)K  
K : ABSORPTION AT 120 BAR FOR C=0, K<1.5cm<sup>3</sup>  
SH : HYDRAULIC SECTIONAL AREA = 3.8 cm<sup>2</sup>  
C : GEAR DISENGAGING STROKE
  9. OPEN PORTS ARE FITTED WITH CLOSURE PLUG FOR STORAGE AND TRANSMIT PURPOSE
  10. CAUTION ; DO NOT ACTUATE THE DEVICE IF NOT FITTED ON ITS MOUNTING BRACKET
  11. WITHOUT STROKE WEAR INDICATOR
  12. DO NOT OPERATE THIS PRODUCT WITHOUT INSTALLATION OR FIXATION ON THE BRACKET

- NOTES**
- ① DEVICE EXTREME POSITION WHEN BLEEDING
  - ② MISALIGNMENT OF PUSHROD IN ANY DIRECTION
  - ③ BOOT THERMAL RANGE -40°C TO +130°C
  - ④ GEAR DISENGAGING STROKE
  - ⑤ POSITION TO NOTE (CLUTCH IN NEW CONDITION)
  - ⑥ STROKE
  - ⑦ DO NOT USE THE TUBE FOR LIFTING PLEASE LABEL TO BE PASTED HERE
- TORQUE FOR CONNECTION**
- ⑧ 25Nm MAX
  - ⑨ 18Nm MAX
  - ⑩ 5<sup>±5</sup> Nm

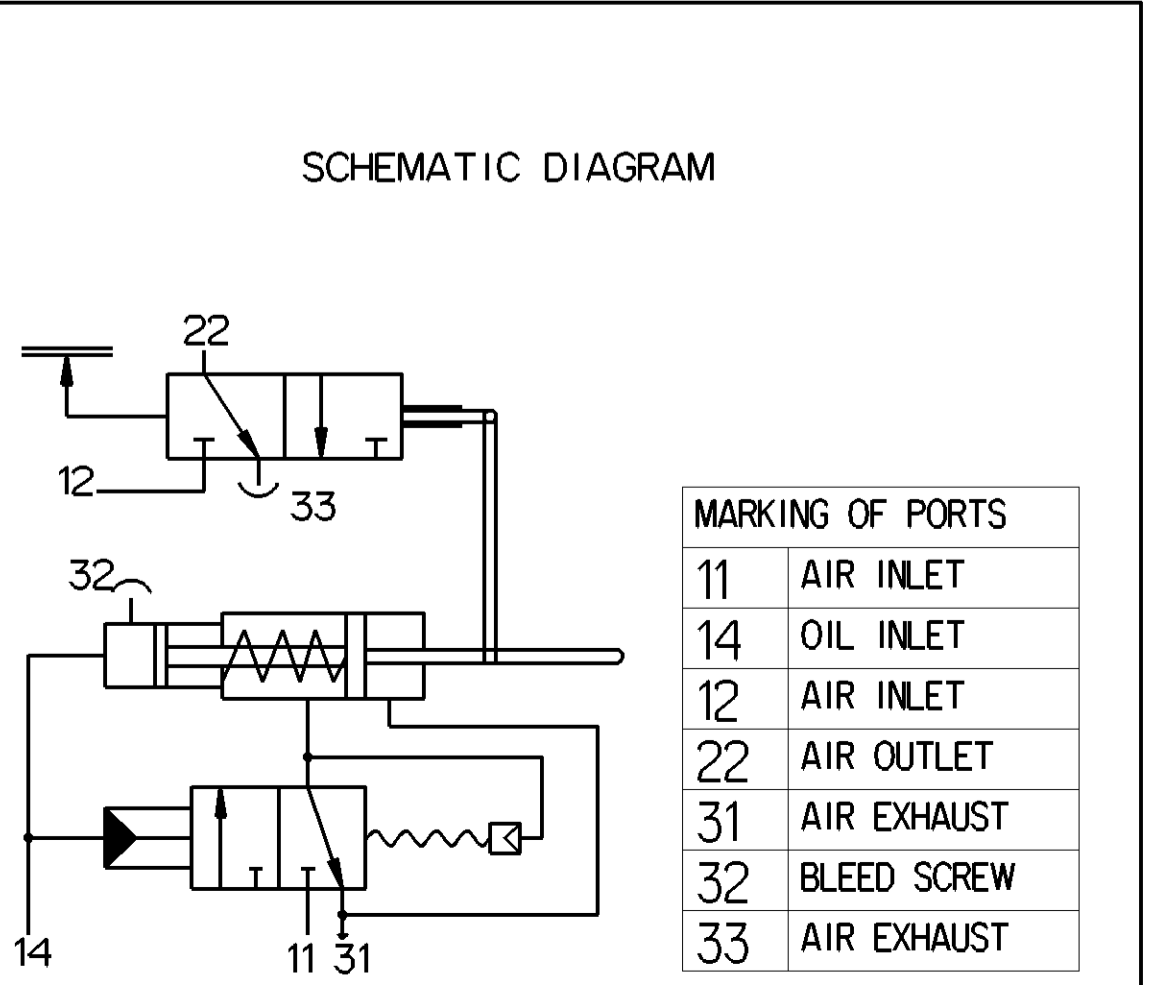
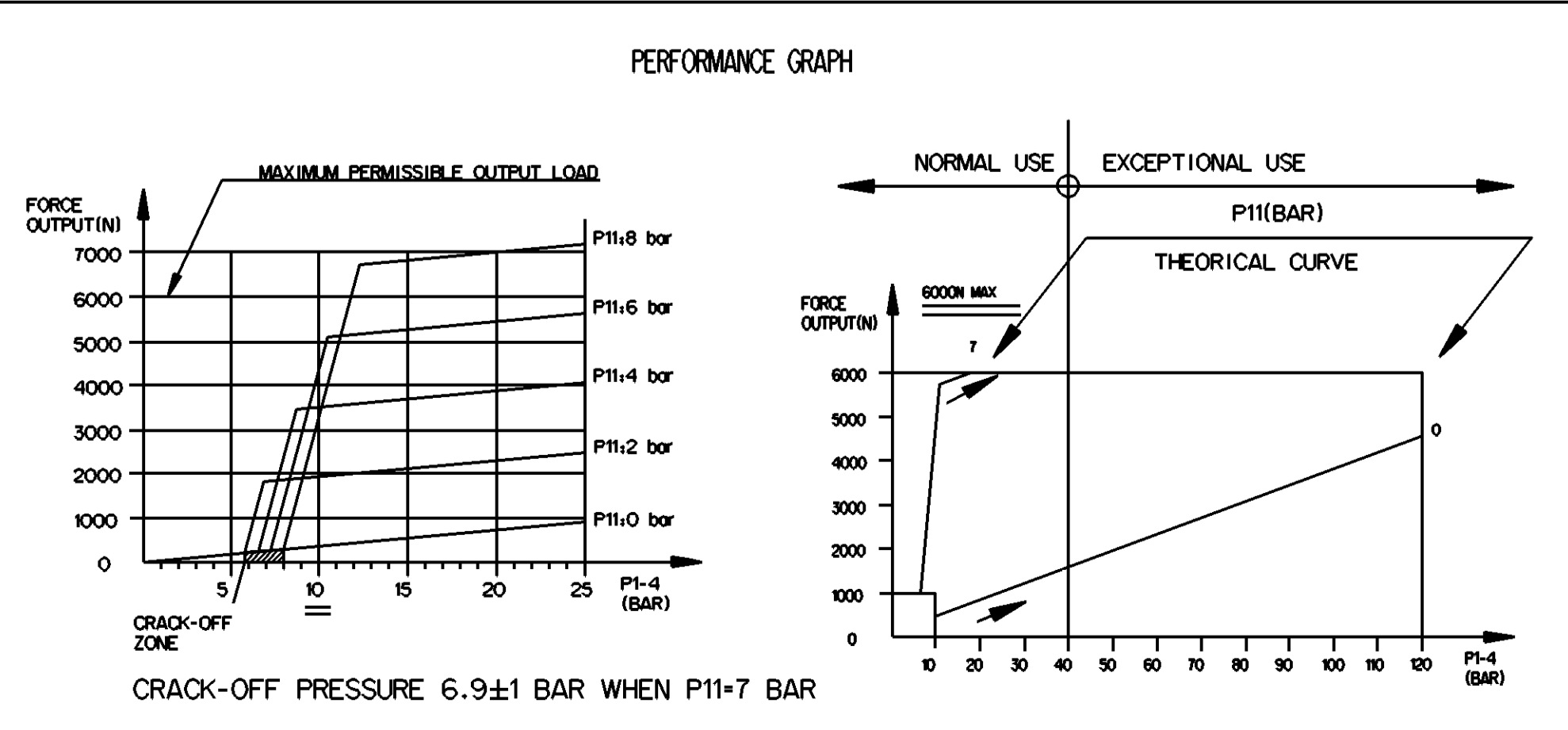
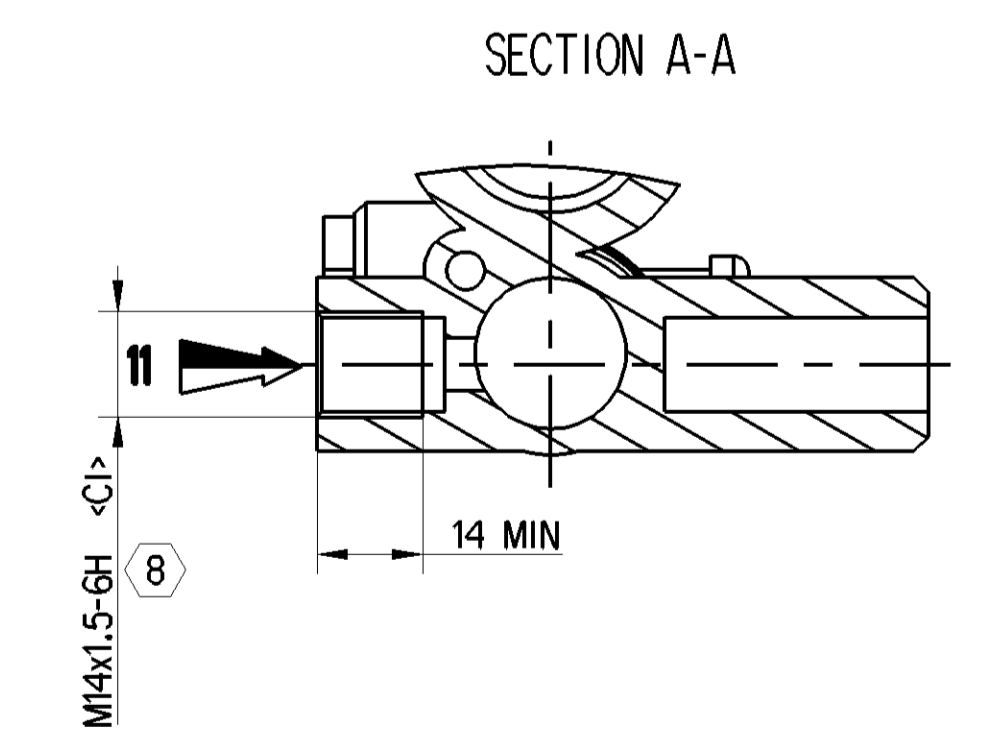
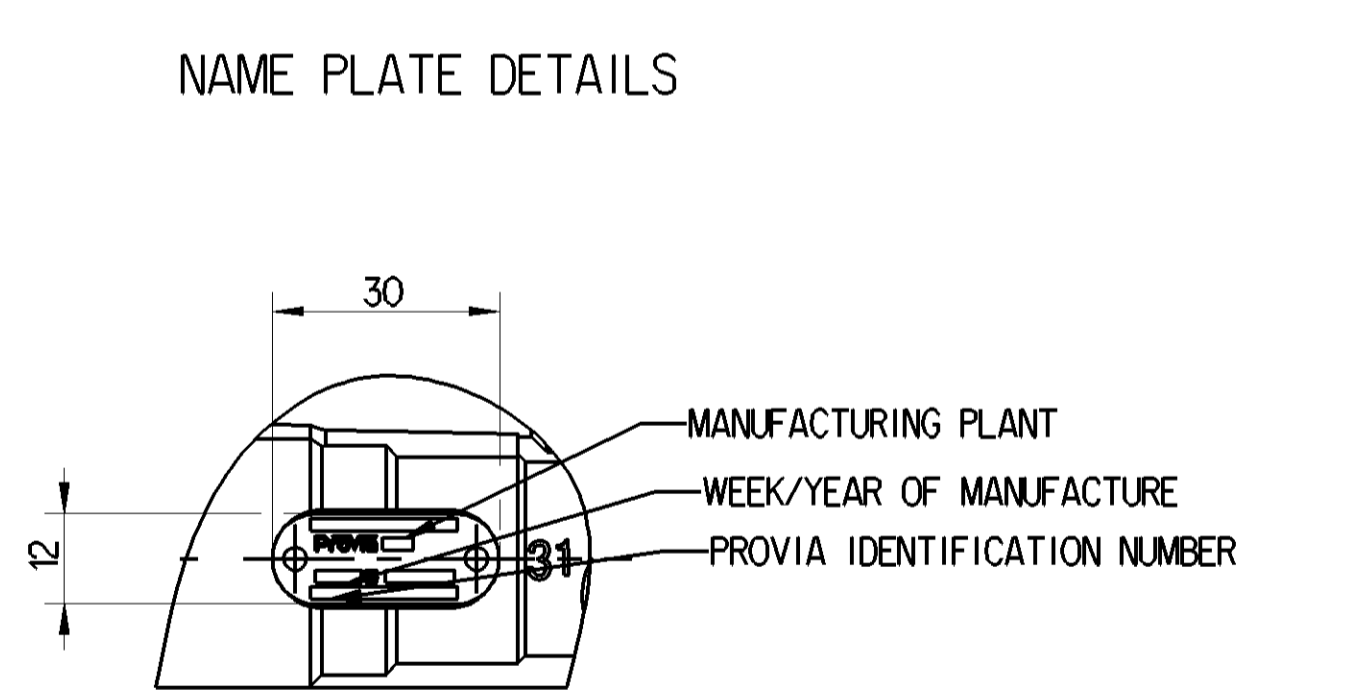
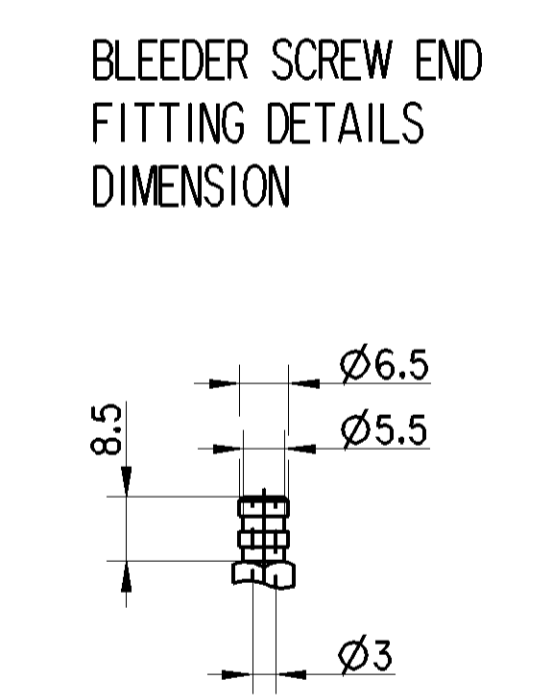
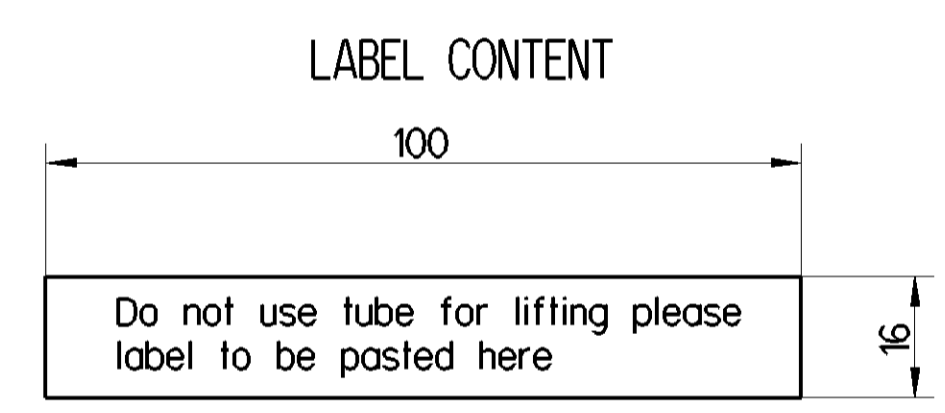
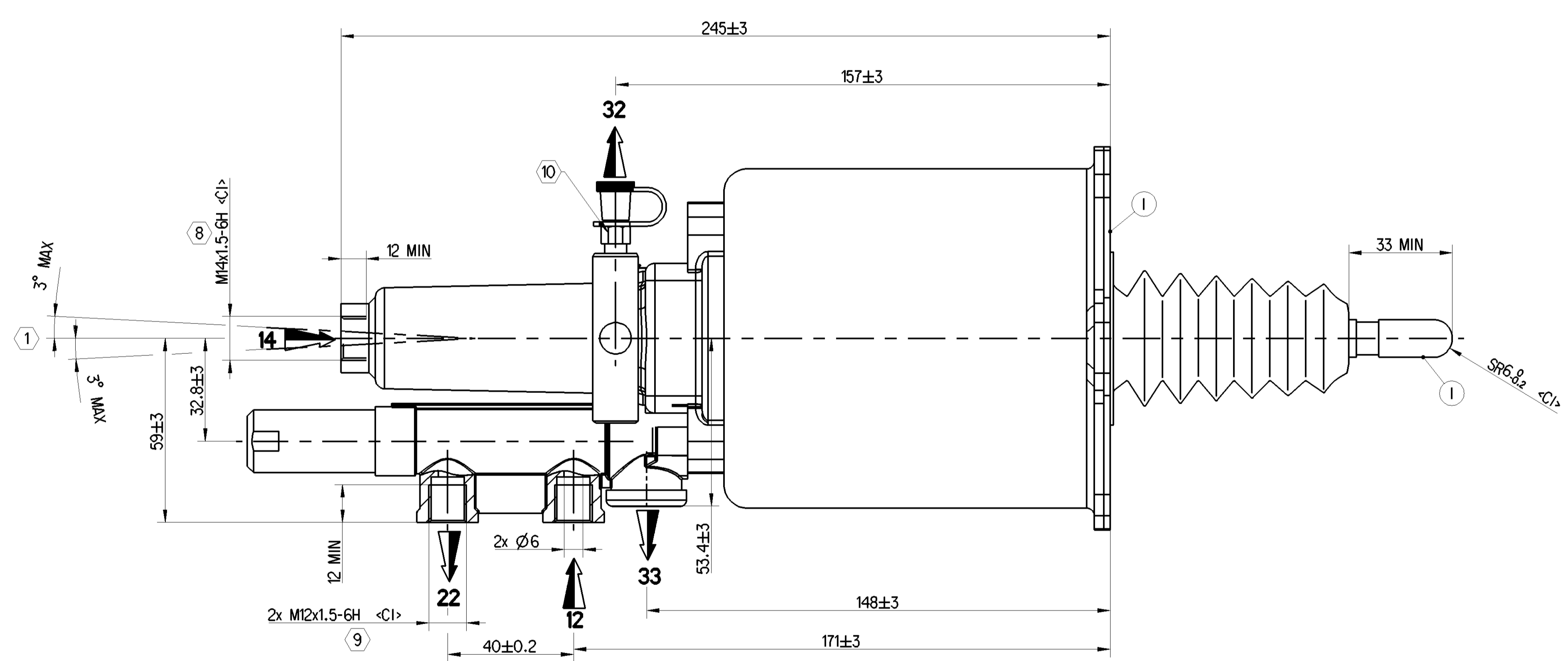

General Specification: ISO 8768, JIS-B 5041, Size (S) 14405 LP		Copyright ©		<b>ProVia</b>	
Further Technical Data: PRO 411 040 O		Date: 2023-11-07		Systech	
Doc. Code: 039		Sheet: 1		To: 13	
General Tolerances: ISO 2011		2023-11-07		Kaiyo	
Class: 10		2023-11-08		Mitsuboshi	
File: 1		2		3	
Medium: X		Ø1		Ø2	
Course: 1		Ø3		Ø4	
Tapped holes acc.:		Ø5		Ø6.5	
Tolerances (mm):		2.6		1.0	
A 0		CREO		NTS	
PRO 411 040 O		005		EN 1/1	